



# WORLD TRADE CENTER MEMORIAL

## Land development & building

### Retaining walls

United States, New York State, New York City

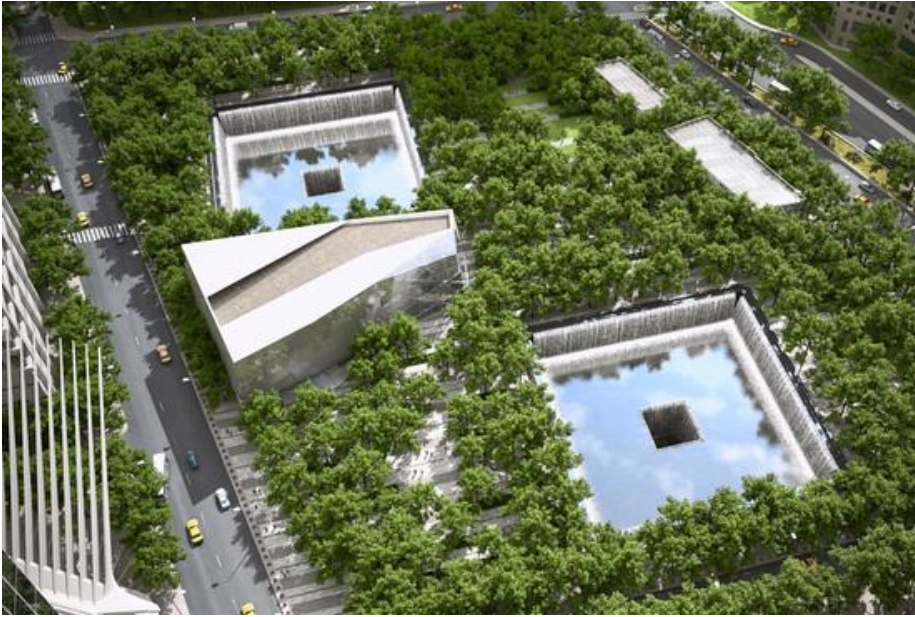

Michael Arad's World Trade Center Memorial, 'Reflecting Absence.' SQUARED DESIGN LAB

#### Owner / Client :

Port Authority of New York and New Jersey

#### Engineer :

Parsons Brinkerhoff

#### Main contractor :

Navillus Contracting

#### Terre Armée entity :

The Reinforced Earth Company (United States)

#### Date :

2013

#### Activity :

Reinforced Earth

#### System :

TerraTrel

#### Reinforcement :

GeoStrap

#### Key figures :

Area : 210 m<sup>2</sup>

Rise: 1.5 m

## The Project

The contractor contacted The Reinforced Earth Company with a need for a temporary retaining wall during phase construction of a portion of the World Trade Center Memorial.

## The Solution

The GeoTrel product was chosen due to the availability of the materials, as well as its simple guidelines for internal stability design. This allowed drawings to be submitted almost immediately, with the materials delivered to the site one week later.

## The Advantages

Construction schedule was the key challenge. The contractor expressed the need for a fast and fully engineered solution that could be delivered to the site quickly.

